

# Bestuhlungsplan 1

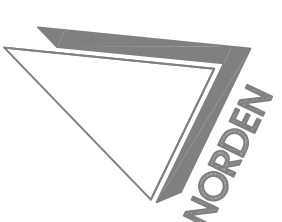





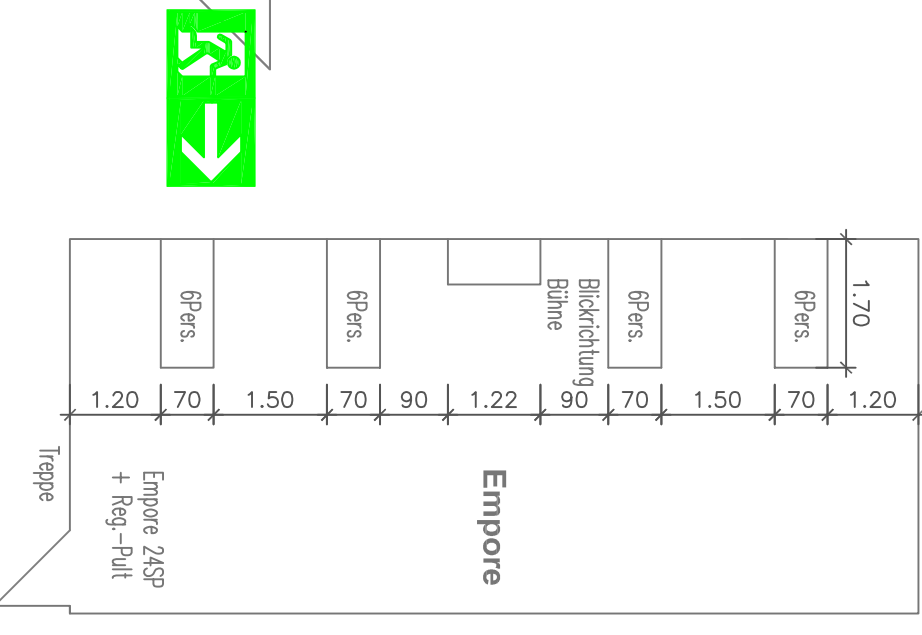
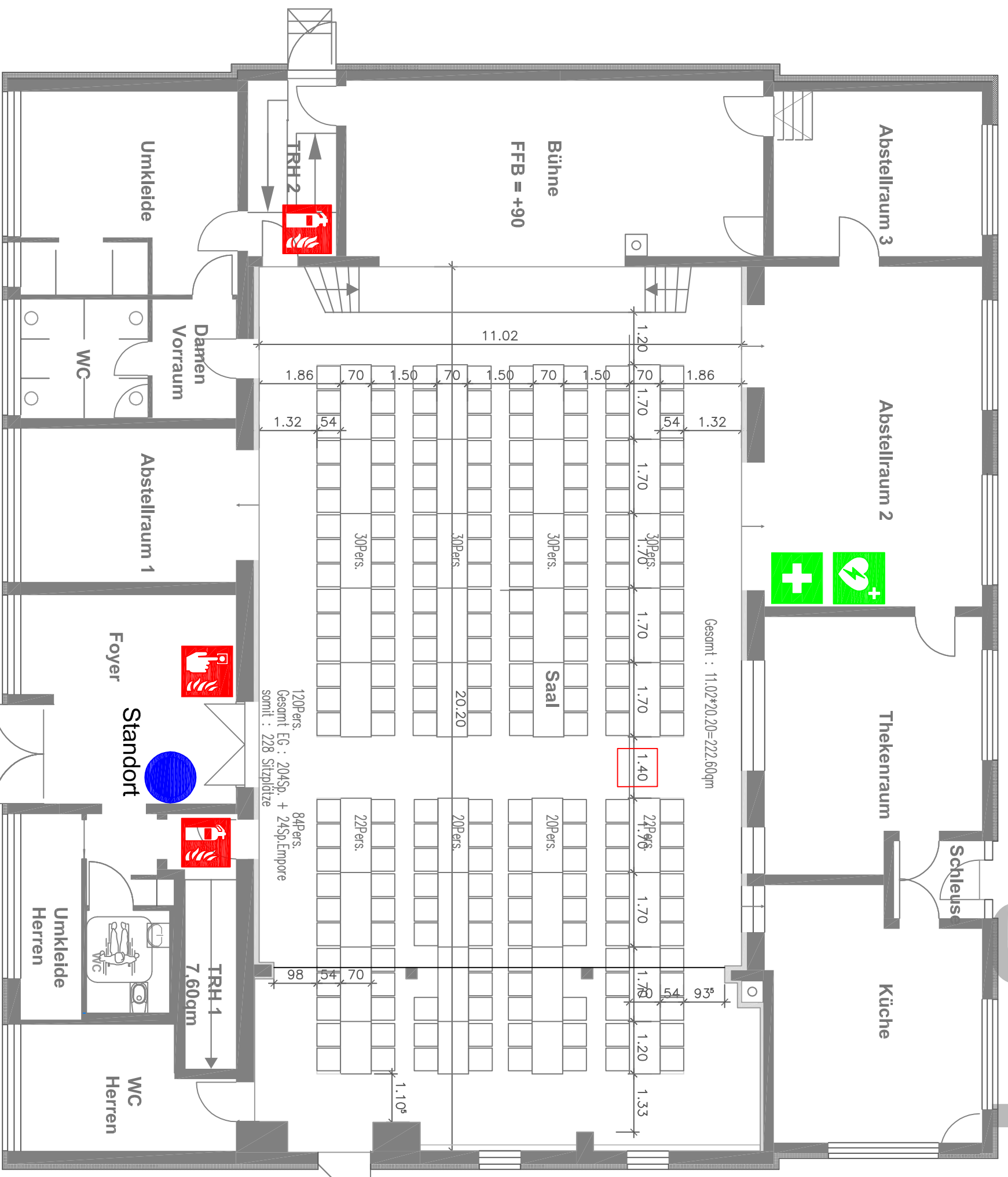

Bestuhlungsplan 1  
Turn- und Festhalle  
in 75050 Gemmingen –  
Stebbach, Jahneweg 2  
Gemarkung Stebbach  
Flurstück 5393

228 Sitzplätze  
Datum : 20.01.2014

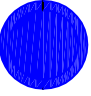
Empore Gesamt :  
11.22(bekkamin)\*4,95=55,54qm



## LEGENDE

-  Standort
-  Feuerlöscher
-  Brandmelder, manuell
-  Richtungs-angabe
-  Rettungsweg / Notausgang
-  Erste Hilfe
-  Defibrillator